

Insulated LongSpan™ wall panel systems - KS1000 LS

Available in 3 profiles Micro-Rib (MR), Mini-Rib (MM) and Euro-Box (EB)

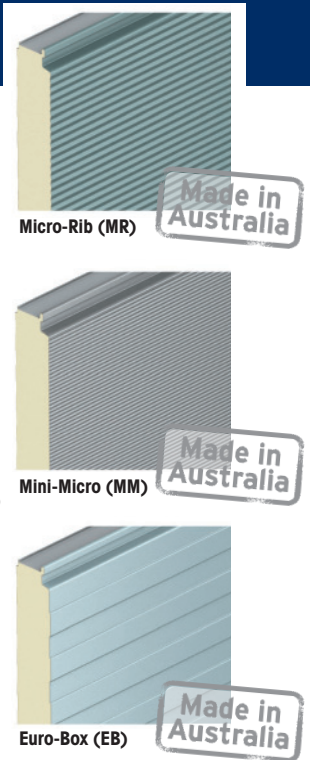
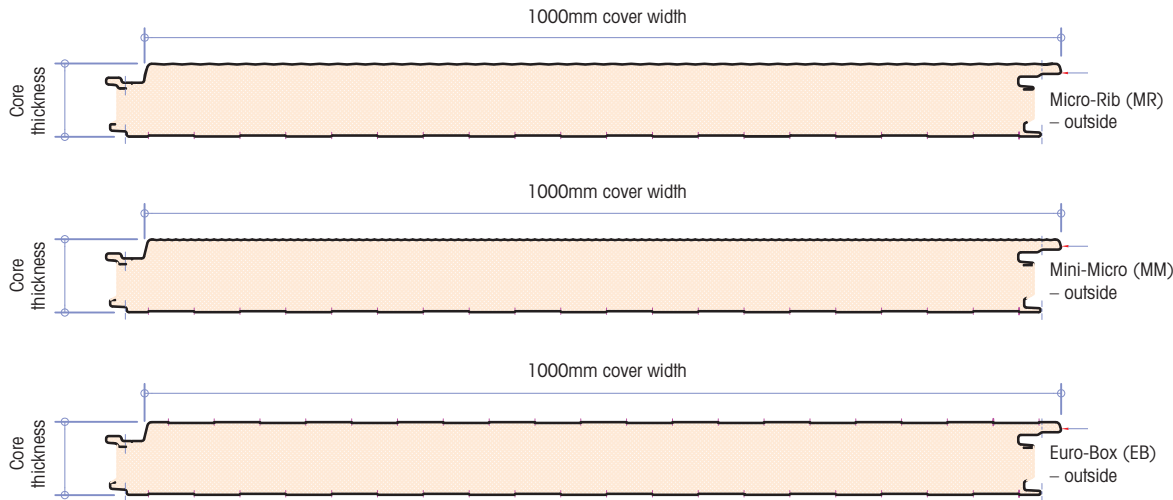

Core thickness (mm)	100	140
R-Value (m ² K/W)	5.15	7.15
Weight kg/m ² 0.5/0.4 steel	13.2	14.8

Deflection Ratio

Pressure = Span/100

Suction = Span/100

Unfactored Load/Span Table (Use calculated design windload values unfactored)

SPAN CONDITION	Core Thickness (mm)	Load Type	Uniformly Distributed Loads (kPa)												
			Span L in Metres												
			3.0	3.5	4.0	4.5	5.0	5.5	6.0	6.5	7.0	7.5	8.0	8.5	9.0
SINGLE SPAN Outer Sheet 0.5mm steel Inner Sheet 0.4mm steel L	100	Pressure/ Suction	5.14	3.88	2.98	2.33	1.85	1.49	1.21	1.00	-	-	-	-	-
	140	Pressure/ Suction	8.07	6.24	4.91	3.91	3.16	2.58	2.12	1.77	1.48	1.25	1.07	-	-
DOUBLE SPAN Outer Sheet 0.5mm steel Inner Sheet 0.4mm steel L L	100	Pressure/ Suction	6.01	4.79	3.89	3.21	2.67	2.25	1.90	1.62	1.39	1.20	1.05	-	-
	140	Pressure/ Suction	8.99	7.26	5.98	5.00	4.22	3.60	3.09	2.67	2.32	2.03	1.78	1.57	1.39

Vertical Joint Options

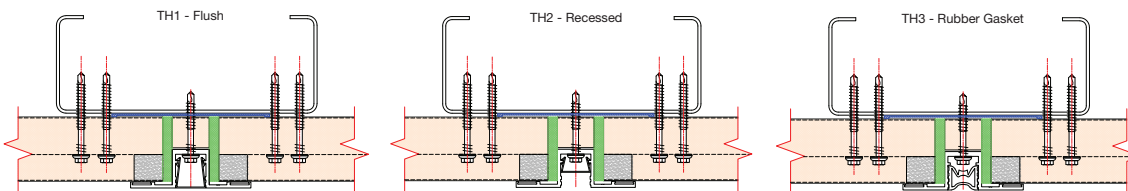

Note:
Number of fixings determined by
fastener calculation - contact
Technical Services for further
information.

For further technical information, please contact Kingspan Technical Services on 1300 799 594.

Kingspan Insulated Panels Pty Limited
Tel 02 9673 5069 **Fax** 02 9673 5068
Email info@kingspanpanels.com.au
 www.kingspan.com.au

